

SO-905 PARTS LIST (2.25" Machined Main Spear)

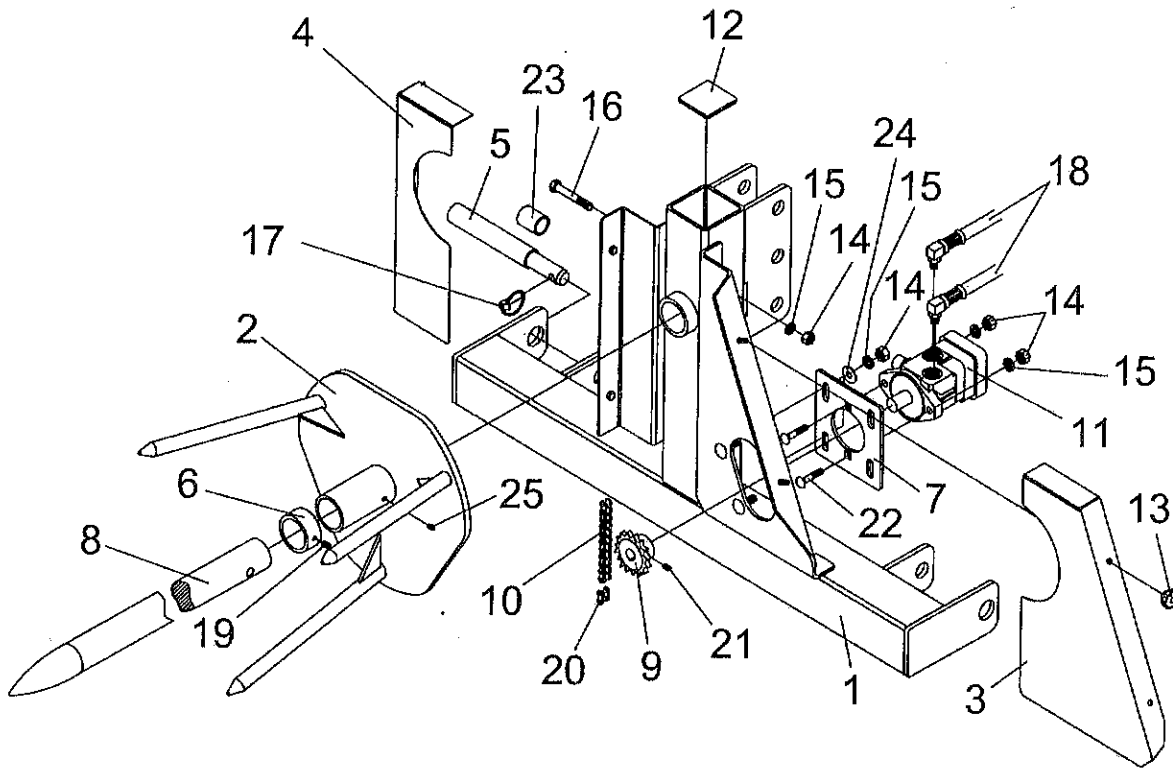

Ref. No.	Part No.	Description	No. Req.
1	830951	Main, Weldment - Spin Off	1
2	830953	Spinner Weldment - Spin Off	1
3	830281	Chain Shield - Spin Off (RH)	1
4	830283	Chain Shield Weldment - Spin Off (LH)	1
5	830290	Hitch Pin - Spin Off	2
6	830942	Collar - Spin Off	1
7	830286	Hydraulic Motor Mount - Spin Off	1
8	830952	Main Spike - Spin Off	1
9	830966	Sprocket - 50B12	1
10	830967	Roller Chain #50 x 43 3/4" (69 Pitches)	1
11	2505640	Hydraulic Motor	1
12	2504300	Plastic Cap	1
13	2504220	Knob - Spin Off	4
14	2500003	Nut, Hex 1/2" - 13NC	7
15	2502002	Washer, 1/2" Spring Lock	7
16	2503313	Bolt 1/2" - 13NC x 5" Hex Head Gr. 5	1
17	590006	Linch Pin 7/16" (AK-14)	2
18	2505633	Hydraulic Hose 1/2" I.D. x 60"	2
19	2503316	Set Screw, Socket 1/2" - 13NC x 1/2"	1
20	480458	Master Link, #50 Chain	1
21	2503057	Set Screw, Socket 5/16" - 18NC x 1/2"	2
22	2503102	Bolt, Carriage 1/2" - 13NC x 1 1/2" Gr. 5	2
23	590126	Lift Arm Bushing - Cat. III to Cat. II (AK-58)	2
24	2501003	Washer, 1/2" Medium Flat	4
25	2504049	Drive Zerk 5/16"	1
N/S	101270	Notice - Grease Zerk	1
N/S	101271	Safety Sign - Danger (Rotating Hay Spike)	1
N/S	101272	Safety Sign - Warning (Moving Chains and Sprocket)	1
N/S	101122	Safety Sign - Warning (High Pressure)	1
N/S	101026	Safety Sign - Warning (Instruction)	1